

JOB NO. 53019 Per # 338517

RDFB 0117

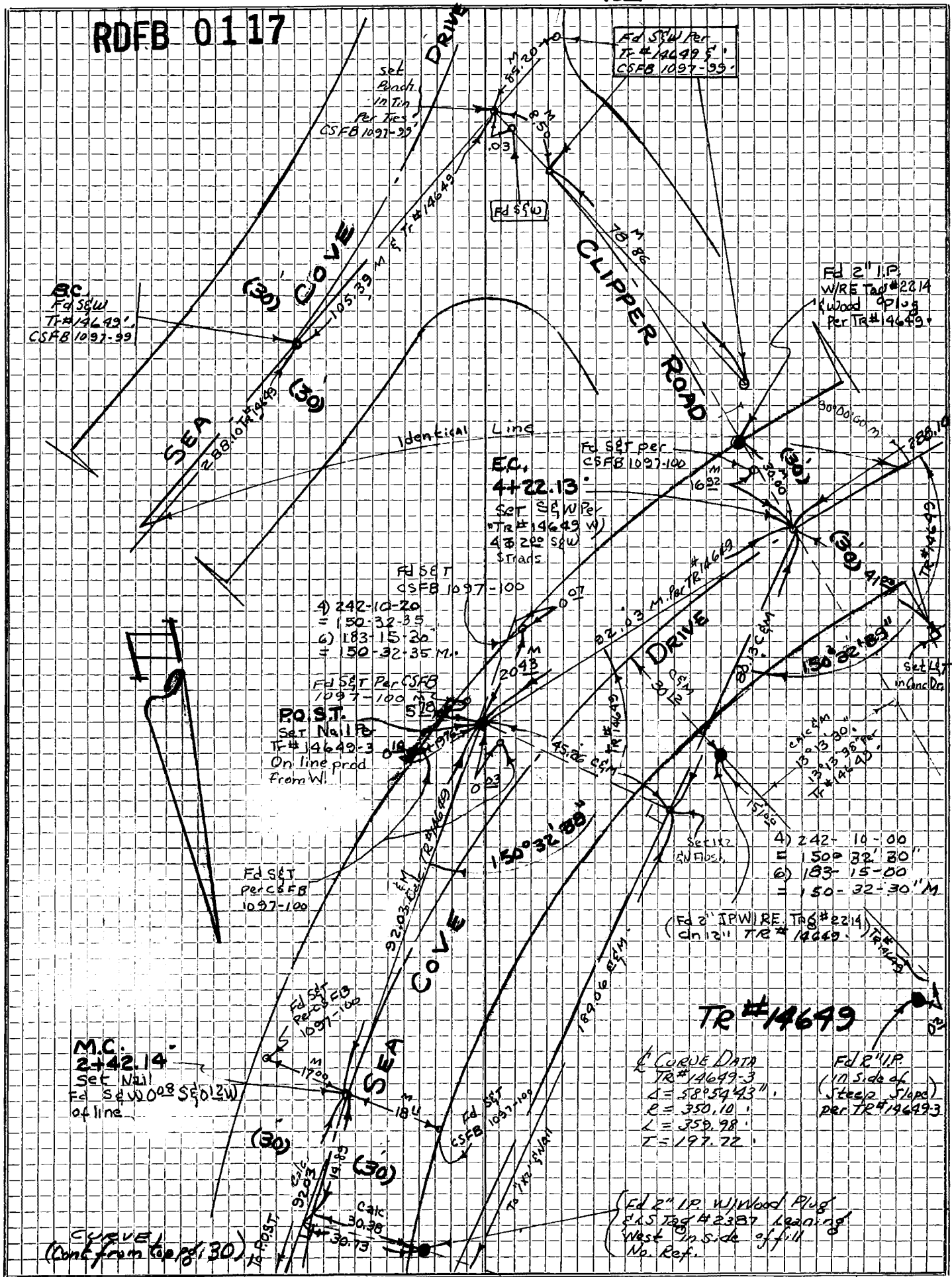

BC
Fd SW
TR # 14649
CSFB 1097-99

Fd SW Per
TR # 14649
CSFB 1097-99

Fd 2" IP
WIRE Tag # 2214
Wood Plug
Per TR # 14649

Fd SW

Fd SW Per
CSFB 1097-100

EQ.
4+22.13
Set SW Per
TR # 14649
48 200 SW
Trads

Fd SET
CSFB 1097-100

4) 242-10-20
= 150-32-35
6) 183-15-20
= 150-32-35 M.

Fd SET Per CSFB
1097-100

POST.
Set Nail
TR # 14649-3
On line prod.
From W.

Fd SET
Per CSFB
1097-100

4) 242-10-00
5) 150-32-30
6) 183-15-00
= 150-32-30 M.

(Fd 2" IP WIRE TAG # 2214)
on 12" TR # 14649

TR # 14649

M.C.
2+42.14
Set Nail
Fd SW 008 S 50 1/2 W
of line

CURVE DATA
TR # 14649-3
C = 589.5443"
E = 350.10'
L = 359.98'
Z = 197.72'

Fd 2" IP
(10' side of
steel Slab)
Per TR # 14649-3

(Fd 2" IP W/ Wood Plug
E.S. Tag # 2387 leading
West in side of fill
No. Ref.

CURVE
(Cont from page 20)

LOS ANGELES COUNTY ROAD DEPARTMENT
ROOM 130 — 1540 HENRY STREET
LOS ANGELES

SURVEY BY Mitchell DATE 1-69
CHECKED BY Bauer DATE 1-10-69