

PWFB 0117

381

CORNER RECORD

Document Number _____

City of RANCHO PALOS VERDES

County of LOS ANGELES, California

Brief Legal Description PALOS VERDES DR. SO. @ BC. 159+23.87E PER PWFB 0117/157A

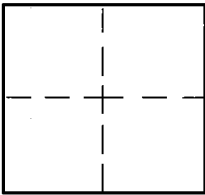

CORNER TYPE

Govt Corner Control
 Meander Property
 Rancho Other
 Date of Survey 11/21/11 & 3/11/12

COORDINATES (Optional)

N. _____
 E. _____
 Zone _____ NAD27 NAD83
 NAD83 Epoch _____
 Elev. _____
 Vert. Datum: NGVD29 NAVD88
 Meas. Units: Metric Imperial

Corner - Left as found Found and tagged Established Reestablished Rebuilt

Identification and type of corner found: Evidence used to identify or procedure used to establish or reestablish the corner:

SEE PAGE 2

A description of the physical condition of the monument as found and as set or reset: _____

SEE PAGE 2

SURVEYOR'S STATEMENT

This Corner Record was prepared by me or under my direction in conformance

with the Land Surveyors' Act on 3/12 2012

Signed [Signature] (P.L.S. or R.C.E. No. 6771)



COUNTY SURVEYOR'S STATEMENT

This Corner Record was received APR 11 2012 MAY 21 2012 SEP 1 2 2012

and examined and filed SEP 17 2012

Signed [Signature] (P.L.S. or R.C.E. No. 6388)

Title: DEPUTY COUNTY SURVEYOR

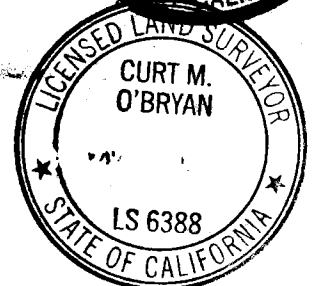

County Surveyor's Comment _____

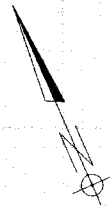

N.T.S.

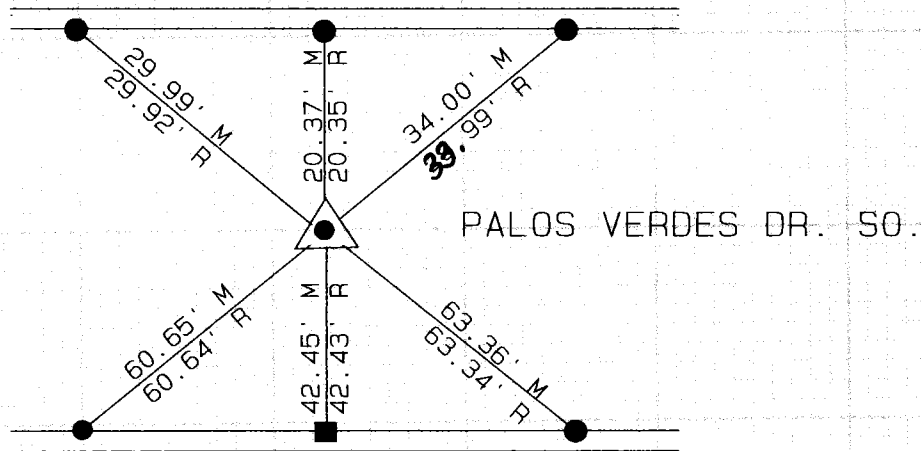

CITY OF RANCHO PALOS VERDES
 THOMAS GUIDE PG. 822
 GRID J-4

R-I = PWFB 0117/157A

▲ FND. SPK/WS D.P.W. PER R-I
 RESET SPK & WS LS6771

B.C. 159+23.87E

● FND L&T PER R-I

■ FND LT&T LS2430 PER R-I

THE PURPOSE OF THIS RECORD IS
 TO PERPETUATE CURRENTLY EXISTING
 MONUMENTS. NO ATTEMPT HAS BEEN MADE
 TO VERIFY THE LOCATION IN RELATIONSHIP
 TO LEGAL BOUNDARIES, PROPERTY LINES
 OR CENTERLINES.