

Los Angeles
Room 144 — 1540 Alcazar Street
DATE 7-25-88
CHECKED BY R.U.

COUNTY OF LOS ANGELES DEPARTMENT OF PUBLIC WORKS
SURVEY BY MENDENHALL DATE 6-7-88

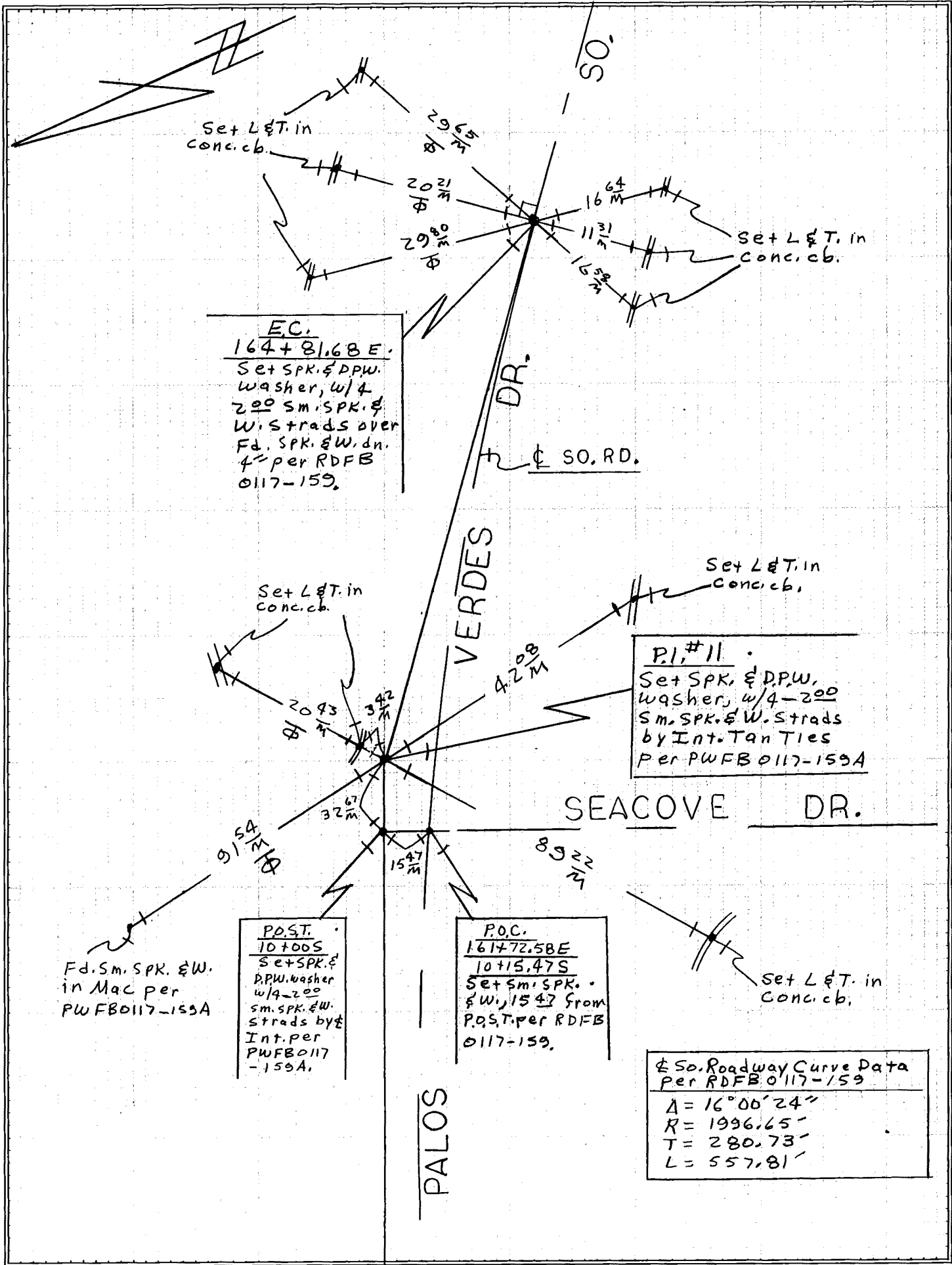

EC.
164+81.68E.
Set SPK. & DPW.
washer, w/4
200 sm. SPK. &
W. strads over
Fd. SPK. & W. dn.
4" per RDFB
0117-159.

P.I. #11
Set SPK. & DPW.
washer, w/4-200
sm. SPK. & W. strads
by Int. Tan Ties
Per PWFB 0117-159A

P.O.S.
10+00S
Set SPK. &
DPW. washer
w/4-200
sm. SPK. & W.
strads by
Int. per
PWFB 0117
-159A.

P.O.C.
161+72.58E
10+15.47S
Set sm. SPK. &
& W., 154.7 from
P.O.S. per RDFB
0117-159.

So. Roadway Curve Data
Per RDFB 0117-159
Δ = 16° 00' 24"
R = 1996.65'
T = 280.73'
L = 557.81'